

HOLLOW

fluxwood



^ Spotted Gum with Black Trim

HOLLOW



The Hollow is a versatile solid timber pendant. The singular LED strip lighting creates a functional yet statement light source that is perfect over kitchen islands and workstations. Available in lengths up to 3m in bespoke hardwoods and lighting specifications. Crafted with a high-quality furniture finish.

Application	Interior Use Only. Must be installed by a licensed electrician.
Size	65 x 37mm
Standard Lengths	1200 / 1800 / 2000 / 2500mm / 2800mm / 3000mm
Bespoke Lengths	Order in increments of 100mm. Max. length 3000mm
Material	Solid Hardwood, Aluminium, Opal Acrylic, Integral LED Lighting
Input Power	240V - 24VDC Transformer
CRI	90
CCT	2700K, 3000K, 4000K
Wattage	19 Watts per metre
Lumens	750lm per metre
Dimming	Leading/Trailing, Dali, 1-10V DC
Mounting	3mm Conductive Cable in Black or Silver
Lead Time	4 weeks for in-stock pendants, 12 weeks for custom builds. Made in Australia.

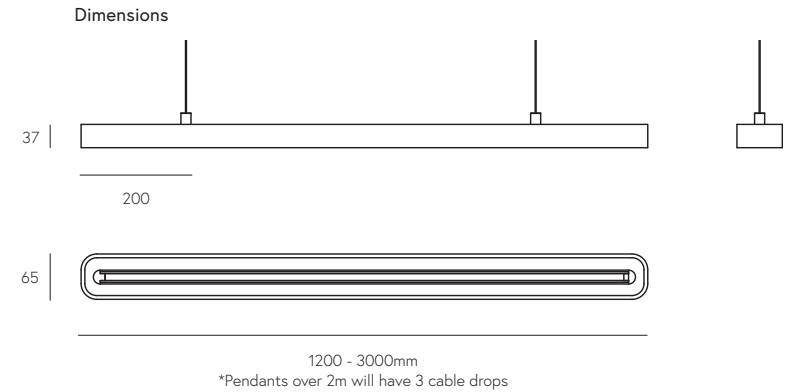

Ordering Options

Timber



Trim

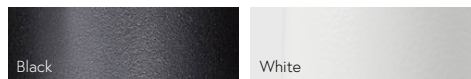

Mounting

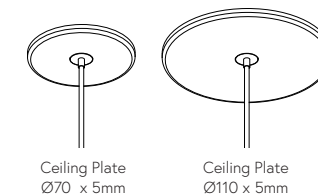

Please specify your order using the codes below (example HW - B - L12 - 1 - 27K - TR - 70W - CS - 2.5m)

Fitting	Timber Selection	Length	Trim Colour	CCT	Dimming Options	Mounting	Cable Colour	Drop Length
HW	Tasmanian Blackwood (B) Victorian Ash (VA) Spotted Gum (SG) Custom (C)	1200mm (L12) 1800mm (L18) 2000mm (L2) 2500mm (L25) 2800mm (L28) 3000mm (L3) Custom (_m)	White (1) Black (2)	2700K (27K) 3000K (3K) 4000K (4K)	Leading/Trailing (TR) Dali Dim (DD) 1-10V DC Control (DC)	Ø70mm White (70W) Ø70mm Black (70B) Ø110mm White (110W) Ø110mm Black (110B)	Silver (CS) Black (CB)	1.5m Standard (1.5) Custom (_m)

HOLLOW Install Instructions



Pendant Installation

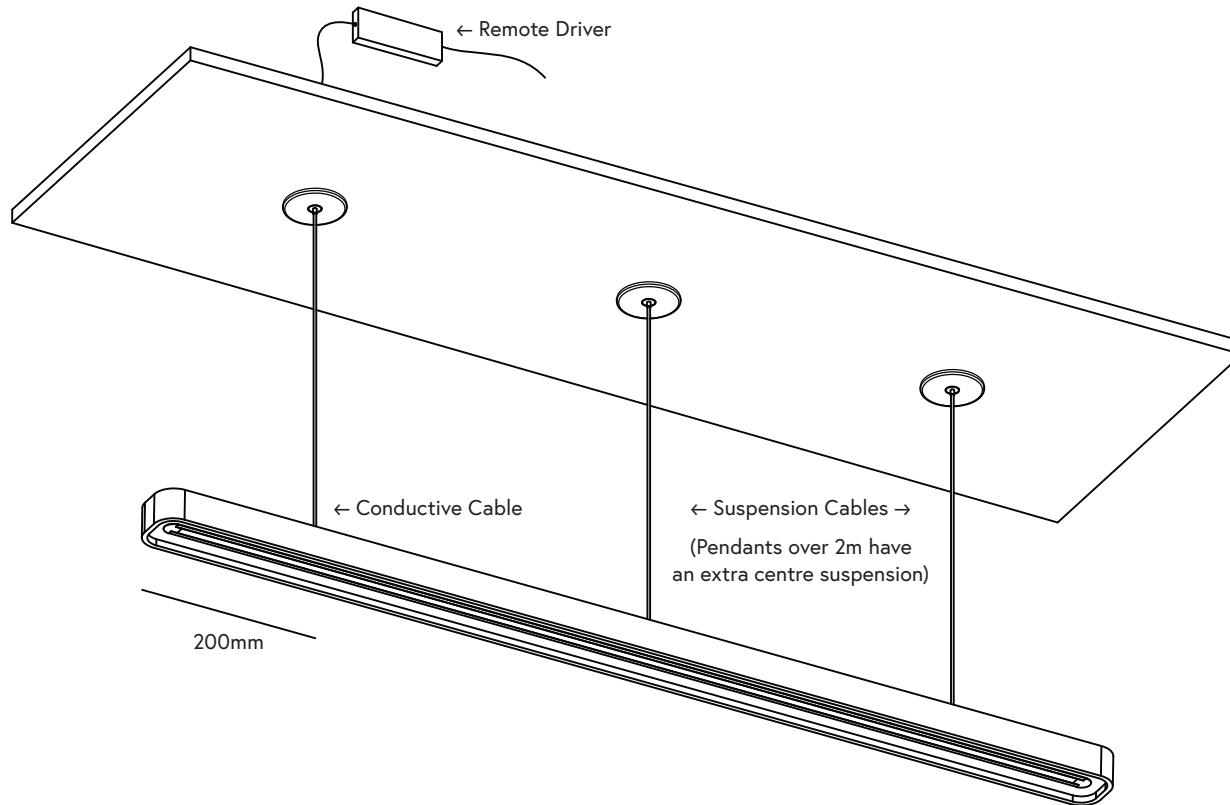

Mounting Plate Options

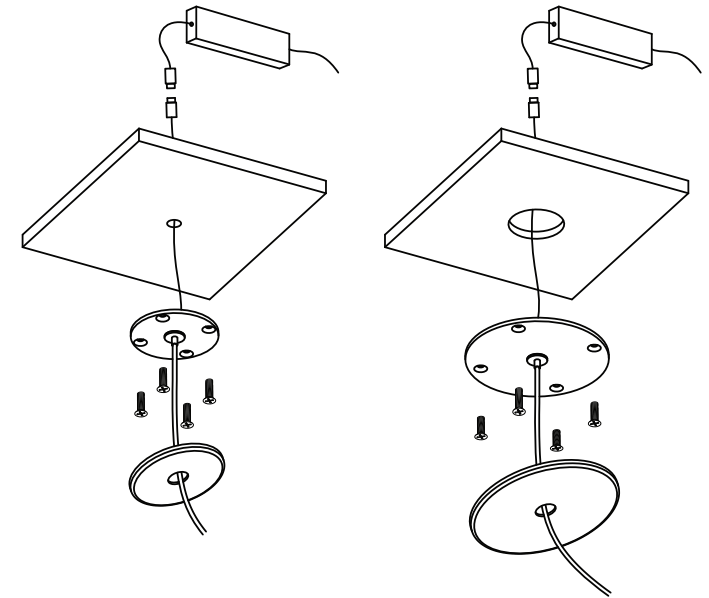

Ceiling Plate
Ø70 x 5mm

Suitable for full ceiling access to place the remote driver from above.

Ceiling Plate
Ø110 x 5mm

Suitable for limited ceiling access to place the remote driver from below.