



Solar Road Markers or lane markers are a low-cost, self-contained, rechargeable, LED illuminated marker. Visible up to 800 metres they are used to reduce speed or signal driver attention to common features, hazards and dangerous bends on our roads. Commonly used on sharp corners, pedestrian refuges, traffic islands and dividing lines. The aluminium casings are rated to 20 tons, single or dual sided in static or flashing modes providing clear and visible traffic guidance in all weather conditions. Multiple colour options are available. The inground spigot ensures the road markers remain located under constant traffic movements. These units require no maintenance and generate no ongoing operational costs.

Luminaire Height	23mm
Lumen Output	48 lm
LED Output	0.2W

FEATURES

- Trafficable, self-contained, rechargeable
- Visible over 800 metres
- Single or dual sided
- Static or flashing modes
- Embedded spigot installation method
- 20 Ton load rating
- > 5 year expected lifespan
- Cast aluminium and polycarbonate construction
- IP67 waterproof rating
- Zero maintenance or ongoing costs
- Various colour options available
- Automatic dusk to dawn lighting
- 2 year warranty for faulty workmanship or component failure not influenced by external mean

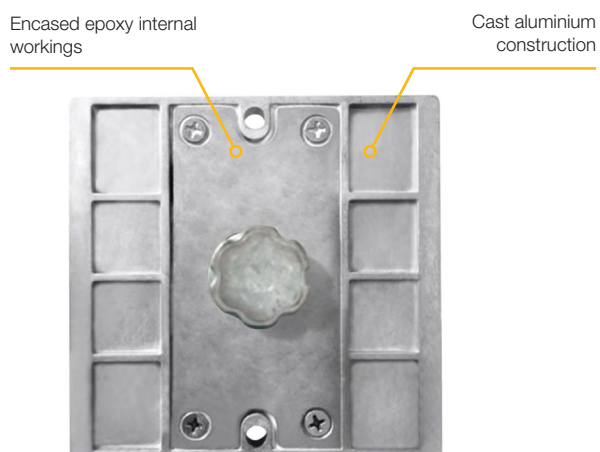

Applications

Roadways | Car parks | Truck depots | Industrial sites

Technical Data

Solar Panel Wattage	0.3W
LED Output	0.2W
Lumen Output	48 lm
Battery Type	Nickel-metal hydride
Battery Specifications	0.6AH 1.2V (0.72 Wh)
Autonomy	> 5 nights
Correlated Colour Temp (CCT)	6000K
Fixture Size	130mm x 118mm x 23mm
Light Source	Epistar F5 LED
Recharge	5 hours
Mounting Height	23mm
Mounting	Surface mount, spigotted
Finish	Aluminum/polycarbonate
Warranty Period	2 years
SKU	SORM20

Mode of Operation

Automatic dusk to dawn lighting. Flashing or static. Multiple colours options available.